

REVISION BLOCK		
REV	DESCRIPTION	DATE
1J	P/N 077-00067 WAS 077-00085. ADDED AUTOSPLICE TO THE VENDOR LIST.	3-22-07
1K	VENDER P/N 9-H140410237LMM WAS C9-H140410237LMM.	4-25-07
1L	QUANTITY PER BAG 5K WAS 25K. "VOID"	7-13-07
1M	CHANGED REVISION LEVEL SO VENDOR CAN CHANGE QTY. PER BAG FROM 5K TO 25K. REMOVE RICAR FROM VENDOR LIST.	10-3-07
1N	CHANGED EDGE BREAK FROM R0.005 TO R0.006 MAX.	8-9-17

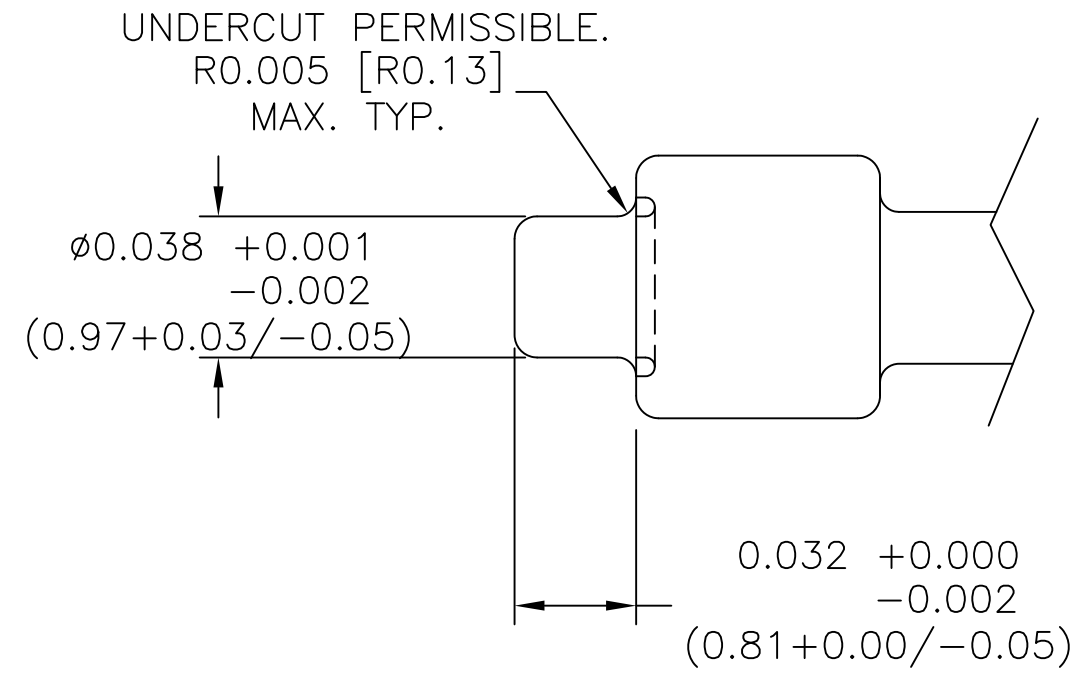

- NOTES:
- 1) INTERPRET THIS DRAWING IN ACCORDANCE WITH ASME Y14.5-1994.
  - 2) PARTS TO BE PACKAGED LOOSE IN A BAG. QUANTITY OF PARTS PER BAG SHALL BE 25K. FOREIGN MATTERS MUST BE KEPT OUT OF THE BAG.
  - 3) MATERIAL: PIN; 1/2 HARD COPPER ALLOY C11000 OR EQUIVALENT.
  - 4) FINISH: PIN; 100-200 MICRO INCHES OF NICKEL PLATING. 300-500 MICRO INCHES OF MATTE TIN PLATE (LEAD FREE).
  - 5) ALL SHIPMENTS MUST BE TESTED FOR SOLDERABILITY PER IPC/EIA/JEDEC J-STD-002, TEST A, CATEGORY 3,

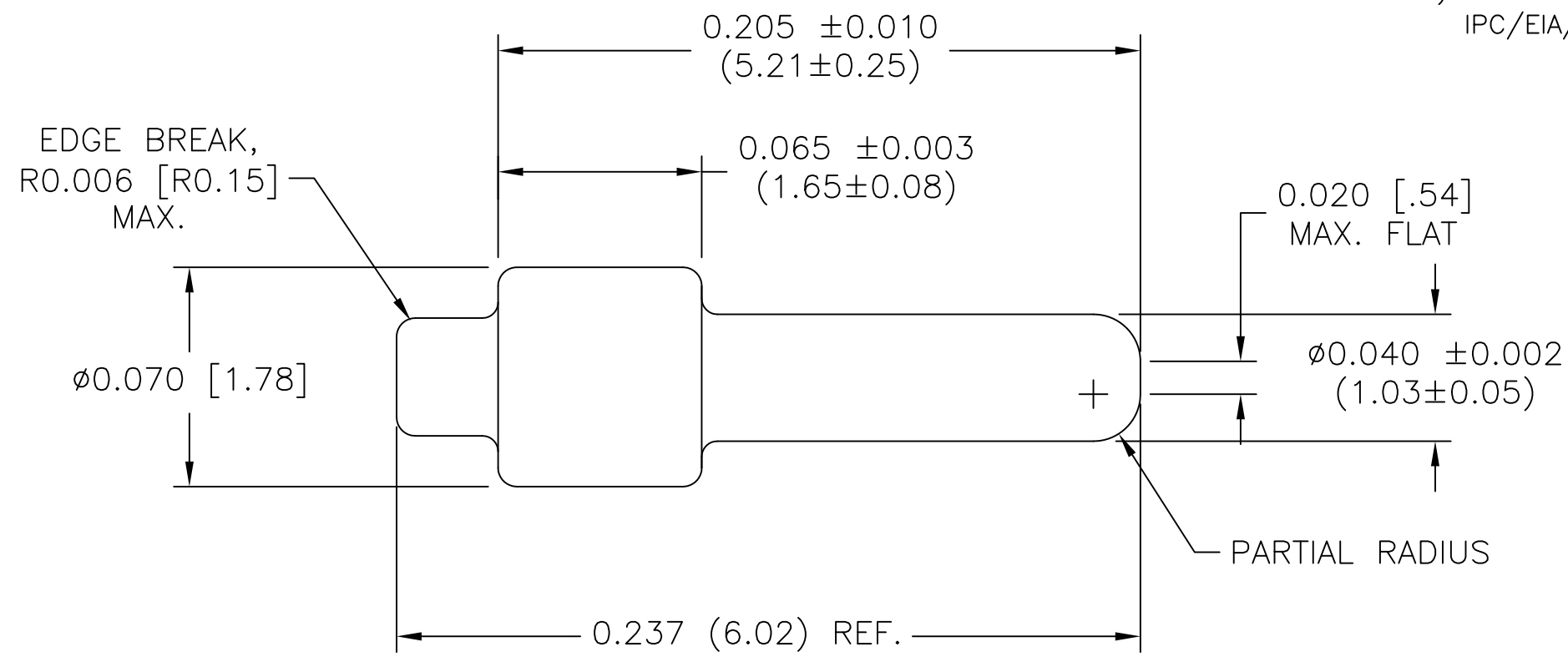

**TEXAS INSTRUMENTS**  
27715 DIEHL ROAD  
WARRENVILLE, IL 60555  
(630) 393-6901

DESC HYBRID PIN, .040 D. .140 L. .065 S.

MATERIAL: SEE NOTE 3.

FINISH: SEE NOTE 4.

COLOR:

E.C.O. No	SIZE	DWG No	REV
	B	077-00067	1N

DO NOT SCALE DRAWING FILE NAME 77-00067\_1L.DWG SCALE SHEET 1 OF 1

**CONFIDENTIAL**

© This document and the information contained herein is confidential and proprietary to Texas Instruments, and may not be reproduced or used for any purpose without the expressed written permission of Texas Instruments.

TOLERANCES UNLESS OTHERWISE SPECIFIED	
.XX = $\pm 0.005$	HOLES = $\pm 0.001$
.XXX = $\pm 0.003$	ANGLES = $\pm 1/2^\circ$

DRAWN	DATE
C. FERNANDEZ	6-15-05
CHKD	DATE
ISSUED	DATE