

4

3

2

1

REV	PCN	REVISION DESCRIPTION	DATE
-----	-----	----------------------	------

NOTES:

- SYSTEM: LITHIUM ION RECHARGABLE
- NOMINAL VOLTAGE: 3.7V.
- NOMINAL CAPACITY: 5800 mAh @ C/5 RATE UNTIL 3.0V @ 23°C ±2°C (C=5800mAh)
- RECOMMENDED CHARGE METHOD: AT A TEMPERATURE RANGE BETWEEN 0°C AND 45°C CHARGE AT 932mA TO 4.2V. HOLD AT 4.2V UNTIL CURRENT DECLINES TO 100mA.
- MAX DISCHARGE RATE: 3300mA CONTINUOUS @ 23°C
- MAX CHARGE RATE: 1630mA
- LIFE CYCLE:> 300 CYCLES @ C/5 TO 80% OF INITIAL CAPACITY
- SELF-DISCHARGE: <10% PER MONTH
- TEMPERATURE: CHARGE 0°C TO 45°C (RECOMMENDED CHARGE)  
DISCHARGE -20°C TO 60°C (STANDARD)  
STORAGE -20°C TO 50°C
- PROTECTION CIRCUIT:  
OVER DISCHARGE CURRENT: 3.4A TO 4.5A @ 23°C±2°C  
OVER VOLTAGE: 4.35V±0.025V PER CELL  
UNDER VOLTAGE: 2.30V±0.10V PER CELL
- PROTECTION AGAINST SHORT CIRCUIT.
- WIRING: RED 22AWG POSITIVE(+)  
BLACK 22AWG NEGATIVE(-)
- ENCLOSURE: PVC SHRINK WRAP
- APPROX WEIGHT: 110gms

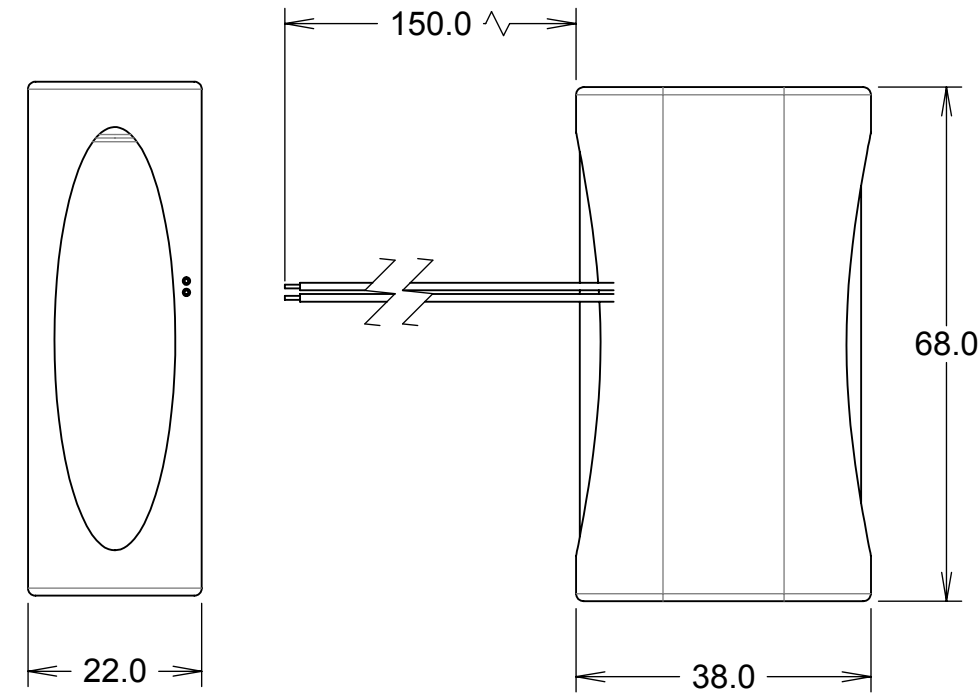
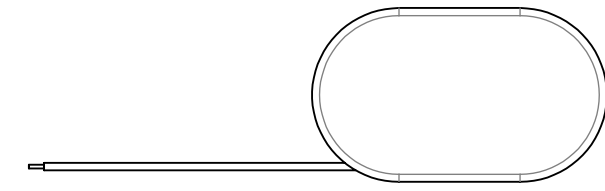
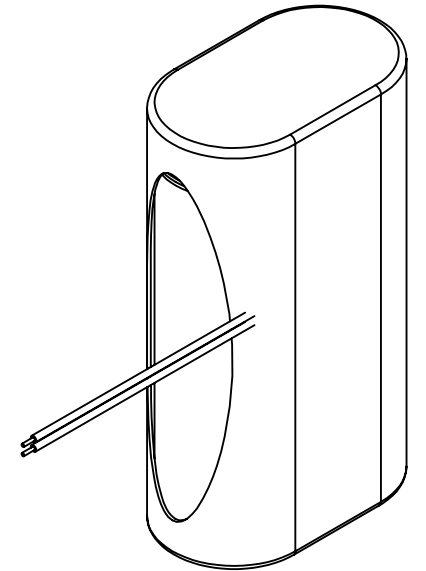

C

C

B

B

A

A

CONFIDENTIAL INFORMATION IS CONTAINED HEREIN. IT IS NOT TO BE USED, REPRODUCED OR DISCLOSED TO OTHERS WITHOUT PRIOR WRITTEN CONSENT BY ULBIPL.					
INTERPRET DRAWING PER ASME Y14.5-2009		DRN	DATE	TITLE	
ALL DIMENSIONS IN mm UNLESS NOTED OTHERWISE		Amar	03 Jul 12	BATT, LI-ION, 18650, 3.7V, 5.8Ah	
TOLERANCE UNLESS NOTED OTHERWISE		CHK	DATE	THIRD ANGLE PROJECTION	PART NO.
$\angle \pm 5^\circ$ X ±0.8 X.X ±0.4 X.XX ±0.13 X.XXX ±0.013		CK	03 Jul 12		
METRIC		ENG	DATE		
MATERIAL	SEE ABOVE	ORIG	DATE		
			DO NOT SCALE		
					SIZE B SHEET 1 OF 1

4

3

2

1