

ELECTRICAL SPECIFICATIONS

MAXIMUM AMBIENT : 80° C
CORE : PQ40/40 TP4 OR JPP-4

INSULATION SYSTEM MUST BE RATED CLASS B (130 C)
OR BETTER

PRIMARY WINDING CONSTRUCTION

INPUT VOLTAGE : 350-420 VDC ,NORMAL 400V
MAX POWER : 1000W WHEN LLC IS OPERATING AT
100kHz MIN FREQUENCY (MAX POWER POINT) : 70kHz
MAX FREQUENCY (MIN POWER POINT) : 130kHz
PRIMARY LEAKAGE INDUCTANCE : TBDμH
PRIMARY TURNS : 16
PRIMARY WIRE : TRIPLE WIRE :0.10mm75C*3P
PRIMARY MAGNETIZING INDUCTANCE : 140 - 160 μH

SECONDARY WINDING CONSTRUCTION

TURNS : 1TS:1TS WITH CENTER TAP

COPPER : 0.35mm*22mm
A,B,C : φ0.32mm*60C

HI POT REQUIREMENTS

PRIMARY TO SECONDARY : 3000VAC, 1 SECOND

PRIMARY TO CORE : SAME
SECONDARY TO CORE : SAME

LABEL:

1000W TRANSFORMER 140~160uH
YAXIN YYWW X

X: REV (版本)
WW: 周 (1; 01; 2; 02)
YY: 年 (2019; 19; 2020; 20)

PCB 尺寸圖

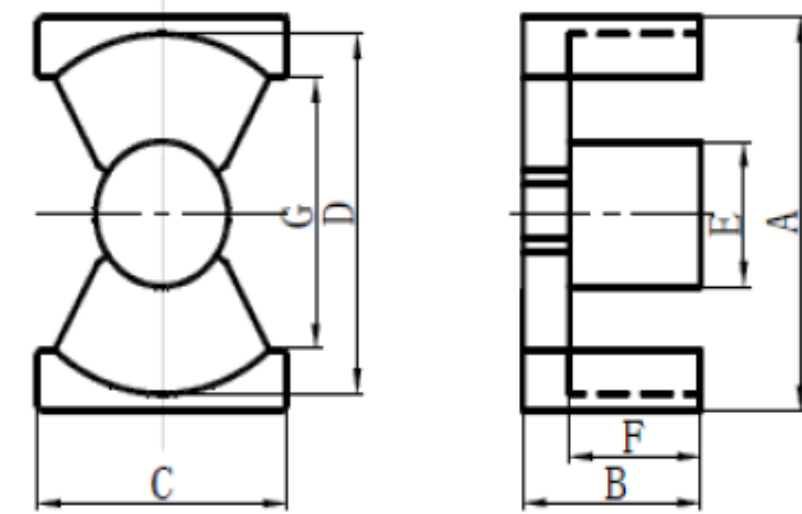
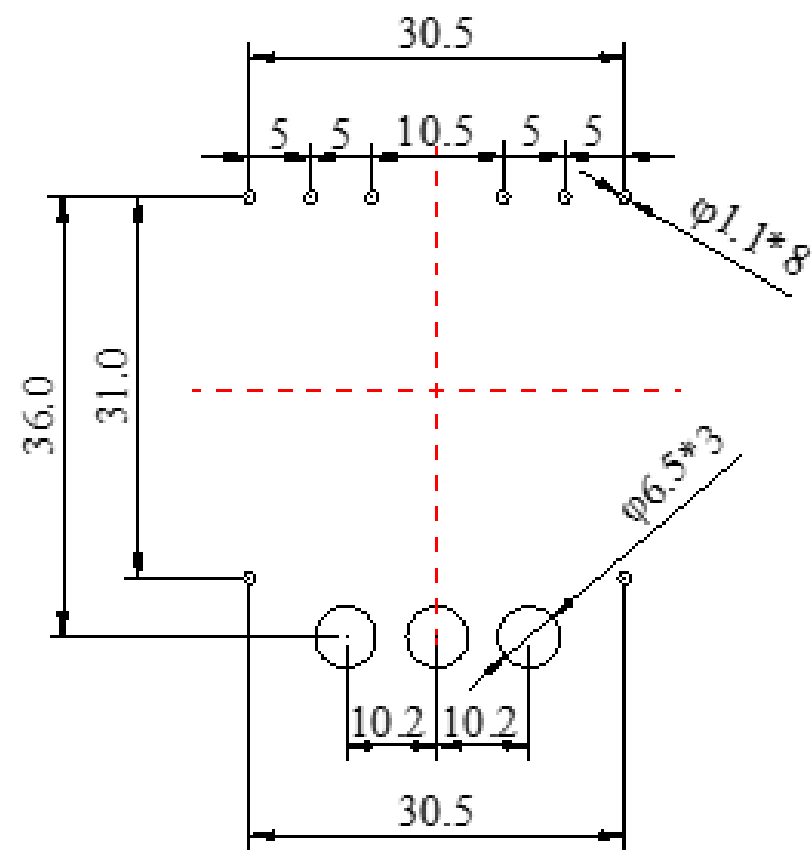
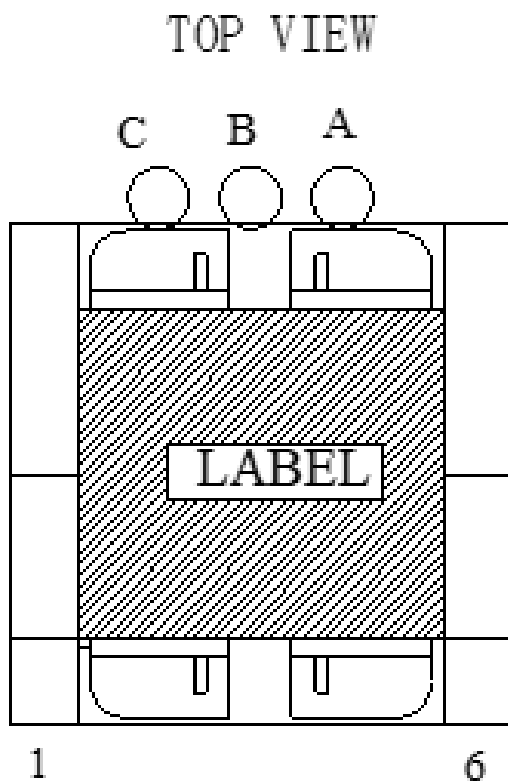
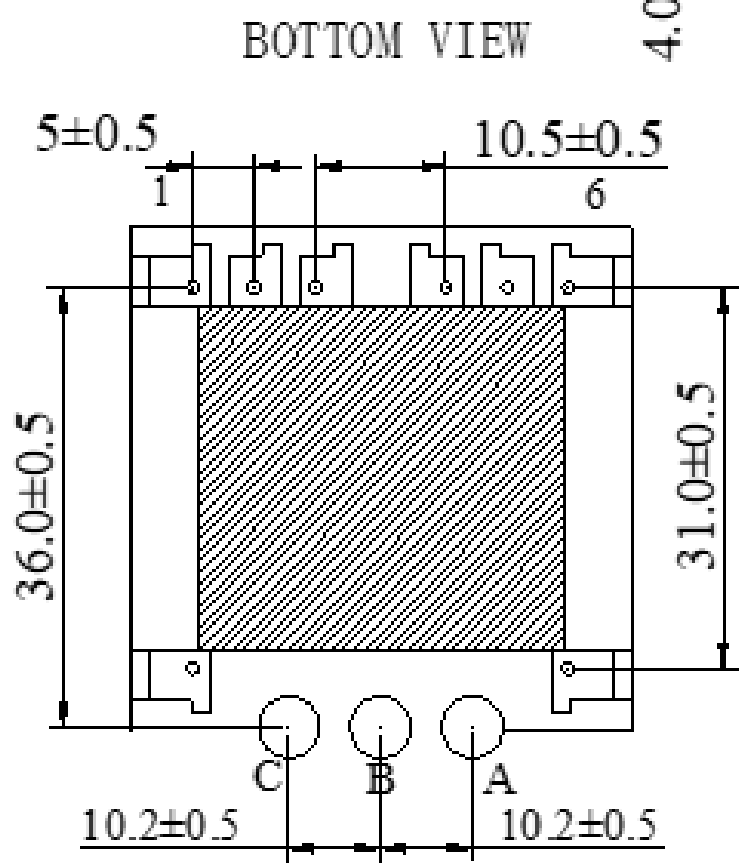
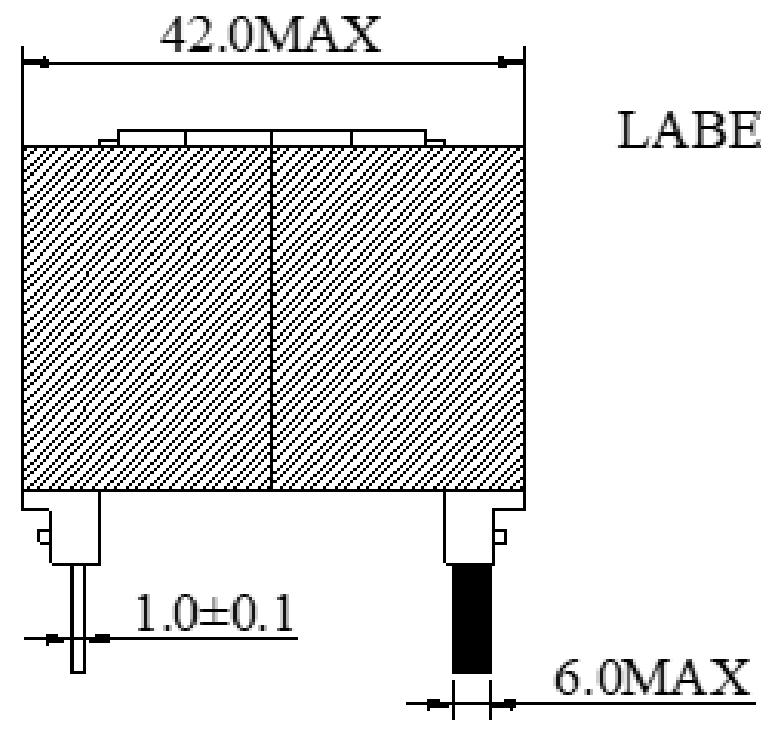
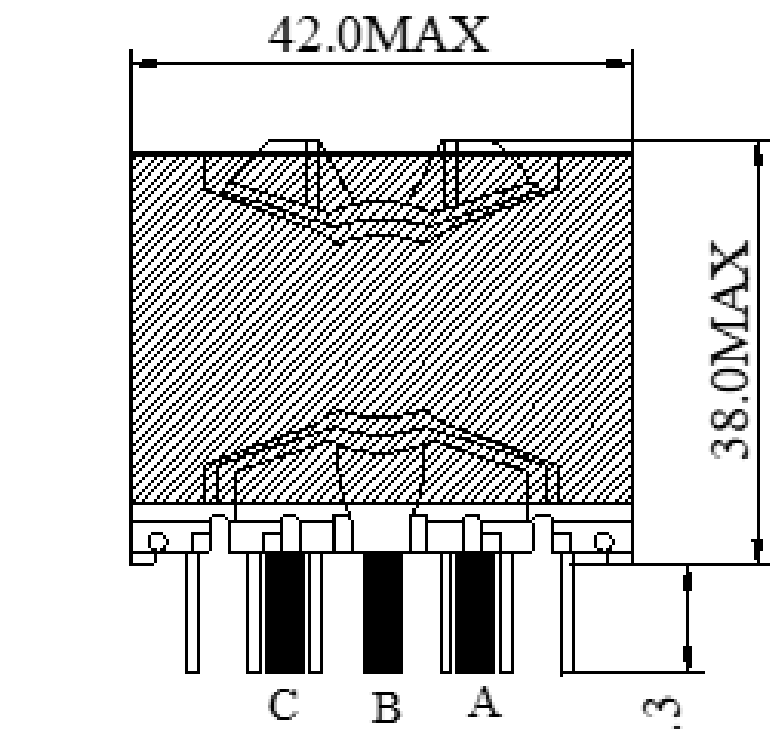

尺寸 DIMENSIONS(mm)	
A	40.7±0.8
B	20.0±0.2
C	27.85±0.55
D	37.4±0.75
E	14.7±0.3
F	14.7+0.3/-0.2
G	28.5min

磁芯参数 CORE PARAMETERS	
有效磁路长度 Effective Length Le	99.7mm
有效截面积 Effective Cross Area Ae	197mm ²
有效体积 Effective Volume Ve	19700mm ³
重量 Approx. Weight W	109.19g/set

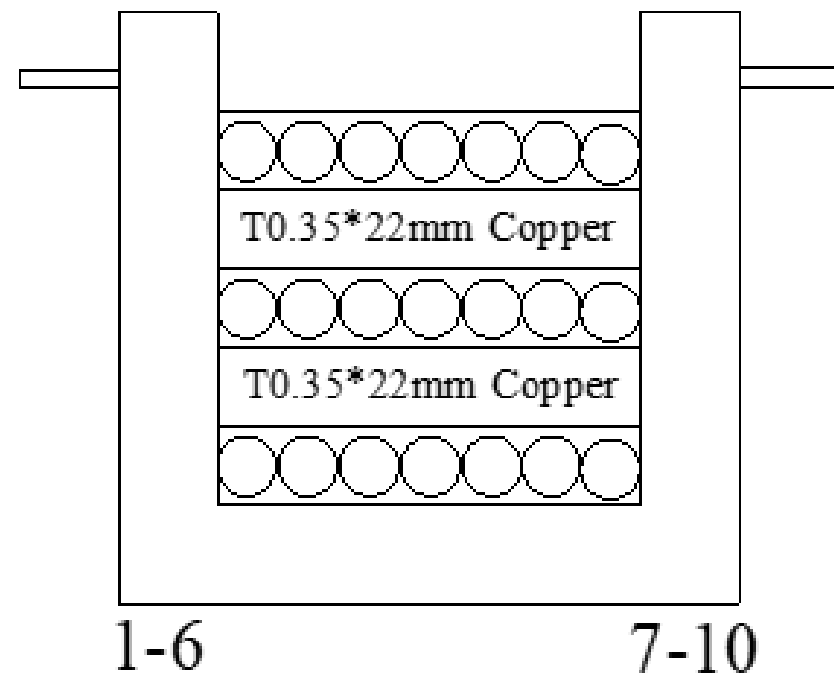
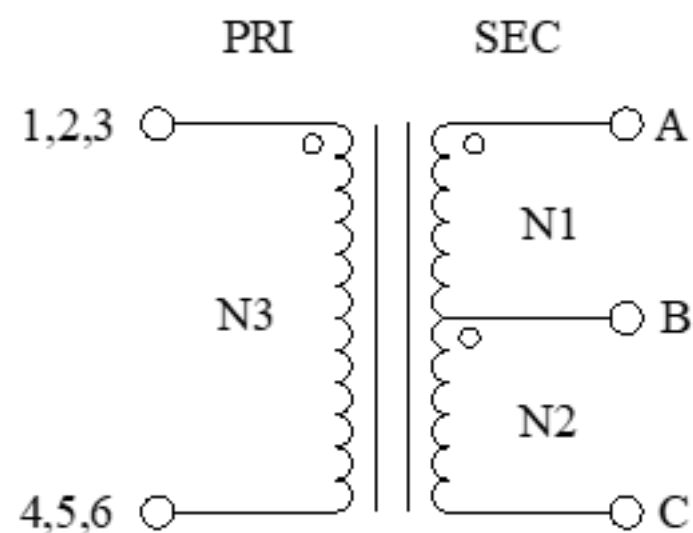

WINDING	WIRE	S-F	TURNS(Ts)	TAPE(Ts)
N3	Φ0.10mm*75C*3P TRW(B)	1,2,3-4,5,6	5	2
N1-N2	0.35*22mm COPPER	A-B-C	1+1	2
N3	Φ0.10mm*75C*3P TRW(B)	1,2,3-4,5,6	6	2
N1-N2	0.35*22mm COPPER	A-B-C	1+1	2
N3	Φ0.10mm*75C*3P TRW(B)	1,2,3-4,5,6	5	2