

# Micro load cell

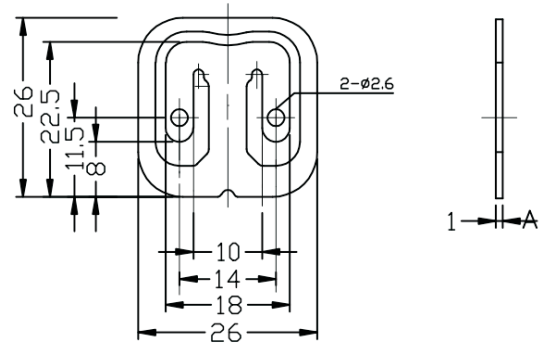

## GML624

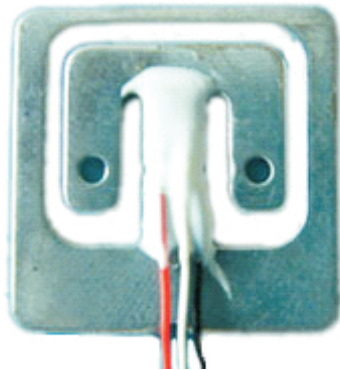

### SPECIFICATIONS

Rated Capacity	3KG , 5KG
Rated output	1.0±0.15mV/V
Comprehensive error	0.1%F.S
Non-Linearity	0.05%F.S
Repeatability	0.05%F.S
Hysteresis Error	0.05%F.S
Creep	0.05%F.S/5min
Temp. effect on Output	±0.1%F.S/10℃
Temp. effect on zero	0.3%F.S/10℃
Zero balance	±0.4
Input resistance	1000±5Ω
Output resistance	1000±5Ω
Insulation Resistance	≥2000MΩ
Excitation voltage	≍ 12VDC
Compensated temp.range	-10~+60℃
Safe Overload	150%F.S