

Gate Drive Transformer

AF4779

FEATURES

- o Manufactured to UL recognized 130 °C insulation system.
- o Materials meet flammability requirements for UL 94V-0.

PRELIMINARY

MECHANICAL

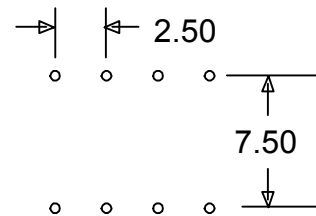
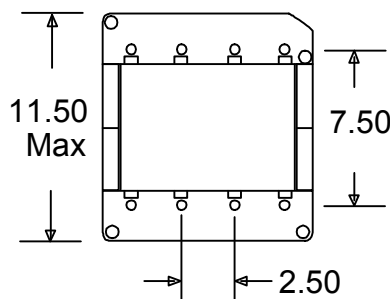
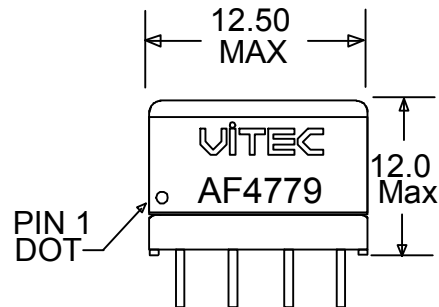

All holes ~ 1.00mm in Dia

SUGGESTED PCB LAYOUT

ALL DIMENSIONS GIVEN IN MM.
TOLERANCES UNLESS OTHERWISE SPECIFIED.
.XX±.15° ANGULAR: ±1°

PACKAGE TYPE: EP10

ELECTRICAL CHARACTERISTICS @ 25 °C

Primary Inductance (1 - 4)*	= 0.90 mH Min
Leakage Inductance (1 - 4), (5-6-7-8) shorted	= 0.35 uH Max
Turns Ratio (1 - 4) : (6 - 5)	= 1 : 1 +/- 1%
(1 - 4) : (8 - 7)	= 1 : 1 +/- 1%
DC Resistance (1 - 4)	= 0.60 Ohms MAX
(6 - 5), (8 - 7)	= 0.60 Ohms MAX
ET Product (1 - 4)	= 50 VuS Min (unipolar)
Dielectric Withstanding Voltage (Primary to Secondaries)	= 3750 Vac
(Secondary to Secondary)	= 1500 Vac

*Note: Tested @ 100KHz, .1V.

SCHEMATIC

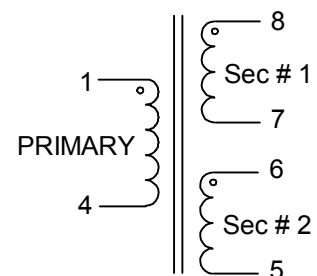

This drawing is the property of Vitec Electronics Corporation. It is not a controlled document. Therefore it is subject to change without prior notice. It's intended use is to supply preliminary information only. Duplication of all or any part of this drawing is prohibited.

AF4779 EP10 032807

VITEC

6213 El Camino Real, Carlsbad, CA 92009
TEL: (760) 918-8831 FAX: (760) 918-8840
<http://www.VitecCorp.com>